

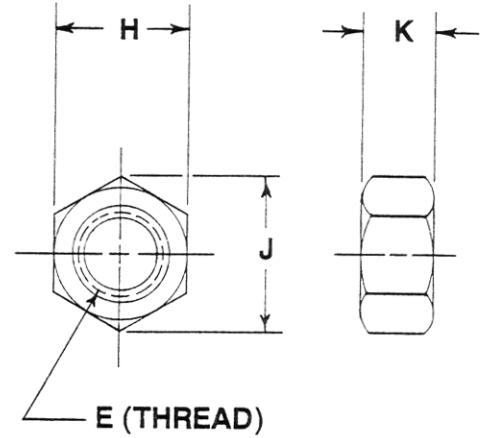

# Threaded Taper Pins

## SPECIFICATIONS – Standard Threaded Taper Pin Dimensions

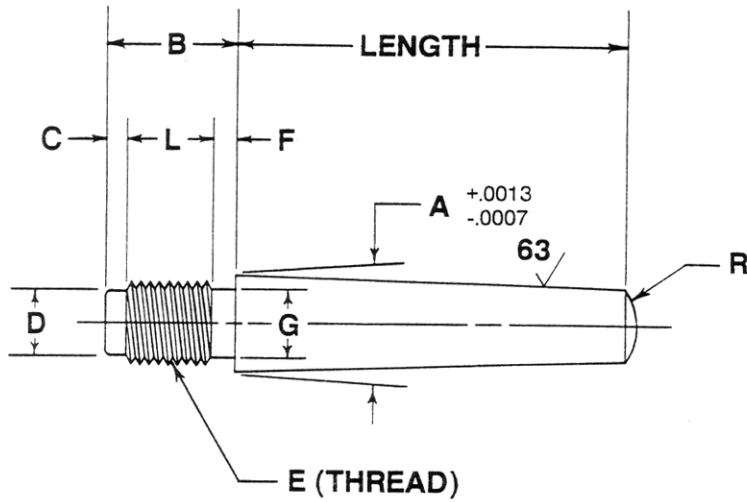

NOTE: Tolerances unless otherwise specified:  
 Taper 1/4" per foot or 0.02083" per inch.  
 Fractions ± .010    Decimals ± .005

Finished Hex Nut  
 SAE Fine Thread  
 (Except #0 & #1 Sizes)

NUMBER OF TAPER PIN	LARGE END DIA. A	THREAD END LENGTH B	NOSE LENGTH C	NOSE DIA. D	UNF FINE THREAD E	NECK WIDTH F	NECK DIA. G	REF. THREAD LENGTH L	APPROX. END RADIUS R	HEX ACROSS FLATS H	HEX ACROSS CORNERS J	HEX NUT THICK. K
0	.154	7/32	1/16	3/32	6-32 NC	—	—	5/32	5/32	5/16	11/32	7/64
1	.170	1/4	1/16	7/64	8-32 NC	1/16	.118	1/8	3/16	11/32	3/8	1/8
2	.191	1/4	1/16	9/64	10-32	1/16	.144	1/8	7/32	3/8	27/64	1/8
3	.217	1/4	1/16	9/64	10-32	1/16	.144	1/8	7/32	3/8	27/64	1/8
4	.248	13/32	5/64	3/16	1/4-28	3/32	.198	15/64	9/32	7/16	31/64	7/32
5	.287	13/32	5/64	3/16	1/4-28	3/32	.198	15/64	9/32	7/16	31/64	7/32
6	.339	15/32	5/64	15/64	5/16-24	3/32	.253	19/64	11/32	1/2	9/16	17/64
7	.407	9/16	5/64	19/64	3/8-24	3/32	.315	25/64	13/32	9/16	5/8	21/64
8	.490	11/16	7/64	11/32	7/16-20	1/8	.368	29/64	1/2	11/16	49/64	3/8
9	.589	3/4	7/64	13/32	1/2-20	1/8	.430	33/64	9/16	3/4	27/32	7/16
10	.704	15/16	7/64	17/32	5/8-18	1/8	.547	45/64	11/16	15/16	1 1/16	35/64
11	.858	1 1/8	1/8	41/64	3/4-16	5/32	.663	27/32	7/8	1 1/8	1 1/4	41/64
12	1.030	1 9/32	9/64	3/4	7/8-14	3/16	.777	61/64	1 1/4	1 5/16	1 29/64	3/4
13	1.239	1 9/32	9/64	3/4	7/8-14	3/16	.777	61/64	1 1/4	1 5/16	1 29/64	3/4
14	1.521	1 7/16	3/16	1	1 1/8-12	3/16	1.000	1 1/16	1 1/2	1 11/16	1 55/64	31/32

Threaded Taper Pins are used whenever a taper pin has to be removed from the driven side! Threaded Taper are .002" smaller on the large end diameter than Standard Taper Pins to allow the Threaded Taper Pin to be inserted approx. 3/32" deeper into the taper-reamed hole. The large end of the Threaded Taper Pin is recessed below the surface which allows the nut to bear on the surface when tightened to pull the pin out. Threaded Taper Pins are used when it is inconvenient or impractical to remove a Standard Taper Pin by striking the small end. Diameters of Threaded Taper Pins allow them to be used interchangeably with Plain Taper Pins.